



VECTORWORKS CASE STUDY



## VECTORWORKS ARCHITECT REVIVES THE VENICE INTERNATIONAL FILM FESTIVAL



INNOVATIVE ITALIAN FIRM  
5+1 ARCHITETTI ASSOCIATI  
USES VECTORWORKS  
ARCHITECT TO CREATE  
THE AWARD-WINNING  
DESIGN FOR THE "NEW  
PALAZZO DEL CINEMA AND  
SURROUNDING AREAS."  
THE NEW BUILDING AND  
SURROUNDING AREAS  
WILL SERVE AS THE  
HEADQUARTERS FOR THE  
WORLD-FAMOUS VENICE  
BIENNALE'S INTERNATIONAL  
FILM FESTIVAL.

Innovative. Ingenious. And indebted to VectorWorks Architect. That's what describes 5+1 architetti associati, of Genoa, Italy, and their award-winning entry for The Venice Biennale's international competition to design the "New Palazzo del Cinema and Surrounding Areas." The new building's primary function will be to house the Venice International Film Festival headquarters. However, it will also serve the communities of Venice and the Lido, as well as provide a model on which to base the refurbishment of the surrounding area.

## THE REQUIREMENTS

"This competition had to fulfill a dual purpose," says Alfonso Femia, lead architect on the project and one of the five principals of 5+1. "On one hand, there was the need for international visibility and expressivity. On the other hand, we had to respect the extraordinary richness and delicate ecosystem of the Venice-Lido system. Because VectorWorks Architect is so flexible, it enabled us to successfully satisfy all the project's requirements."

The structure had to meet the local administration's strict requirements, which included incorporating the surrounding areas, accommodating other public use, permitting pedestrian and vehicle traffic access along the adjacent seafront and preserving existing trees.

## THE SOLUTION

According to Femia, the solution he conceived would not have been possible without VectorWorks Architect.

"The flexible NURBS surface and solids modeling tools in VectorWorks Architect gave us complete control over the fluid shape we were trying to create, and we achieved exactly the results we needed," says Femia.

The design was an exercise in evolution. A mostly subterranean structure that's firmly grounded in magical realism, according to Femia, the 90-meter-long longitudinal hall is covered in a

mixture of resin and natural materials to convey a metaphysical aspect to the structure.

*"The flexible NURBS surface and solids modeling tools in VectorWorks Architect gave us complete control over the fluid shape we were trying to create, and we achieved exactly the results we needed."*

"The hall design process took a long time and went through many metamorphoses, so we relied heavily on the 3D modeling capabilities VectorWorks Architect offers to depict each version we conceived," explains Femia. "Using VectorWorks, we were able to create a 2400-seat hall that was both an accurate and aesthetically pleasing answer to the functional requirements of the competition."

One wall is comprised of an intricate filigree of glass panels representing a dragonfly's wing and overlooking the gardens outside. While this wall with irregular glass panels presented a particular challenge to the 5+1 team, "again, VectorWorks Architect solids modeling tools helped us create the shapes we envisioned."

*"Using VectorWorks, we were able to create a 2400-seat hall that was both an accurate and aesthetically pleasing answer to the functional requirements of the competition."*

## THE WINNING PRESENTATION

When it came time to prepare drawings to present to the Venice Biennale, viewports came in handy.

"The presentation of the project is just as important as the project itself," says Femia. "With viewports, laying out all our drawings is a lot simpler. We can assemble all final sheets in VectorWorks, which saves us an enormous amount of time."

"We decided to present our competition drawings on a black background, and we knew that it could only be possible with VectorWorks Architect to have such precise control of line thickness for clarity and readability," adds Femia. "Viewports allowed us to page images, drawings and text in different scales, giving us total control over line thicknesses and colors."

Femia thanks VectorWorks for this latest accolade to add to their achievements.

"We have always used VectorWorks Architect, and we can surely say VectorWorks Architect is a complete software program for our needs and most certainly for architecture," he says. "In winning this international design competition, VectorWorks Architect has helped us attain our highest professional and personal goals."

*"The presentation of the project is just as important as the project itself. With viewports, laying out all our drawings is a lot simpler. We can assemble all final sheets in VectorWorks, which saves us an enormous amount of time."*

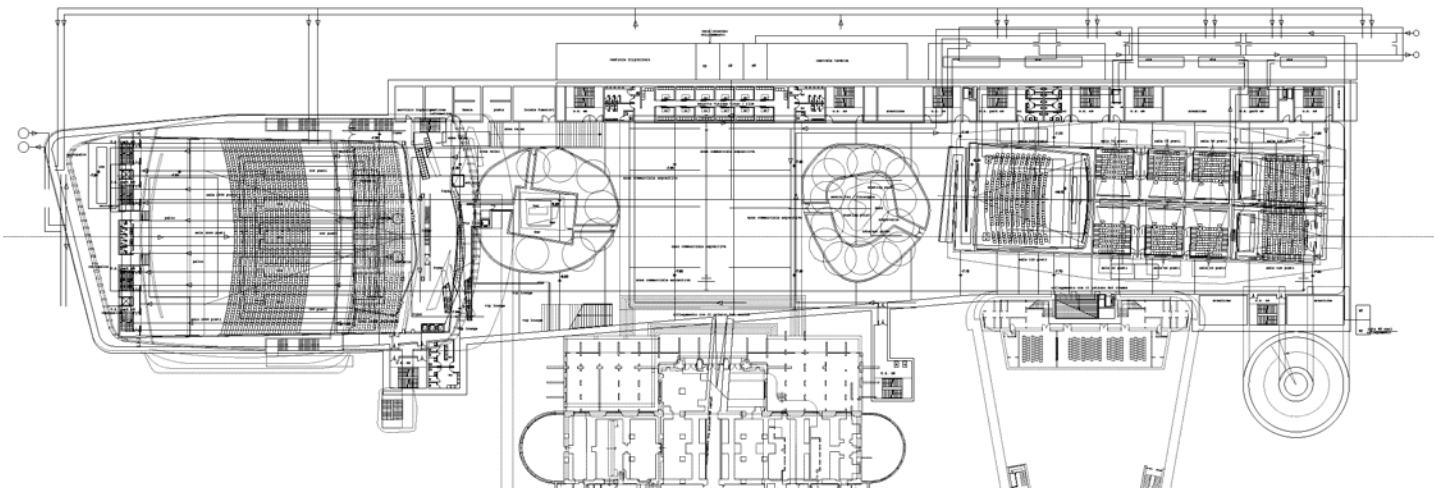

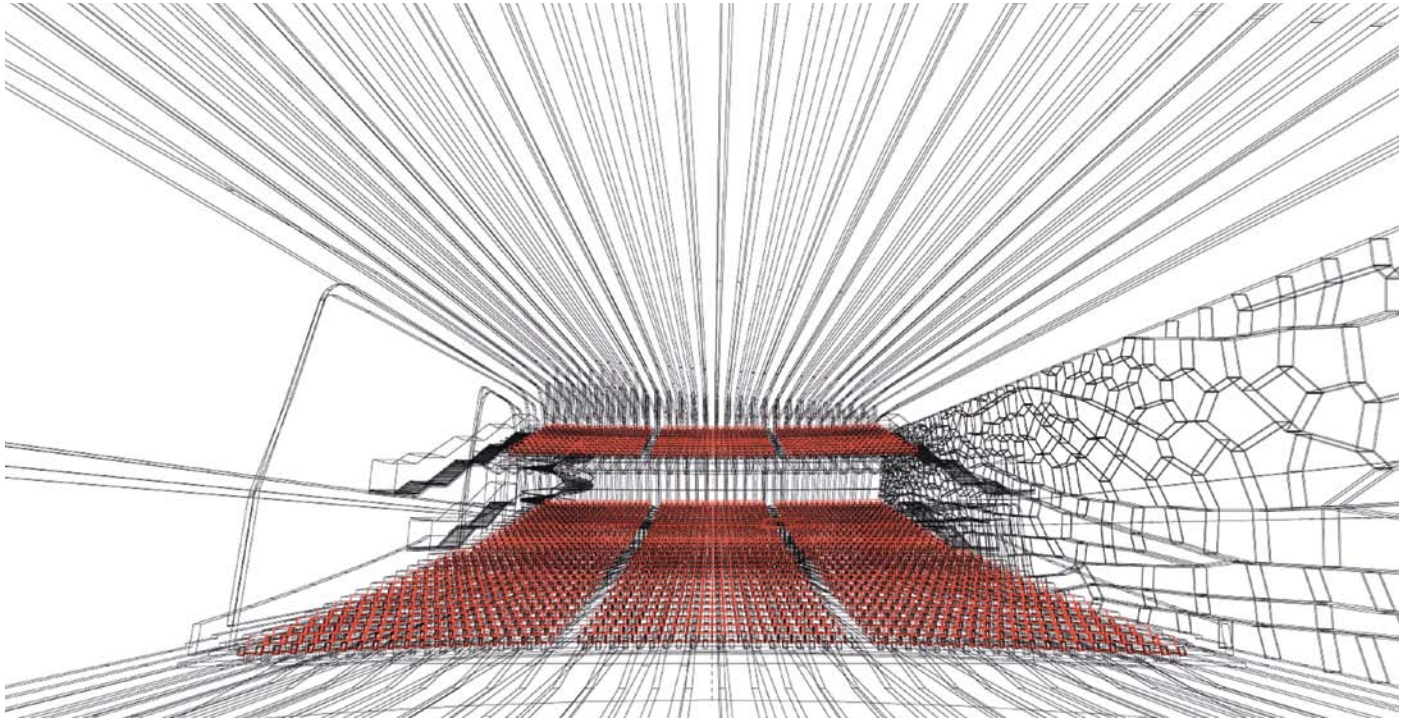

## THE COMPLETE SOLUTION

For a multi-disciplinary firm that takes on projects of all sorts and sizes—from residential and commercial architecture to space planning, interior design and graphic design, having a software program that can address all its needs is essential. And that's one of the biggest benefits of VectorWorks Architect, according to Femia.

"One of the most important aspects of VectorWorks Architect for us is that it's a complete software package," affirms Femia. "Drafting tools allow us to draw accurate 2D drawings. Flexible NURBS surface and solid modeling tools allow us to create realistic 3D models. Thanks to viewports, it's possible to layout entire projects. And complete DWG/DXF support helps us communicate with outside consultants who work with different software programs."

He continues, "Our design teams are comprised of people with different tasks who must all work together. It's critical for everyone to work with the same software, so there's no slowing down when deadlines are looming—and VectorWorks Architect allows us to do that without missing a beat."

*"One of the most important aspects of VectorWorks Architect for us is that it's a complete software package."*

## THE ISO 9001 STAMP OF QUALITY

Since 5+1 architetti associati has adopted the ISO 9001 certificate of quality, it is critical for drawings to follow a particular standard. All symbols, libraries, drawing borders and title blocks must be uniform.

"VectorWorks Architect provides us the best tools to update and standardize our libraries quickly, in order to adhere to the strict ISO 9001 standards," says Femia. "Furthermore, architects who join our firm must quickly adapt to a new, rather rigid methodology of work—one that VectorWorks Architect makes fairly easy. Thanks to VectorWorks Architect, new architects trained on AutoCAD are able to become completely operative in no more than one week.

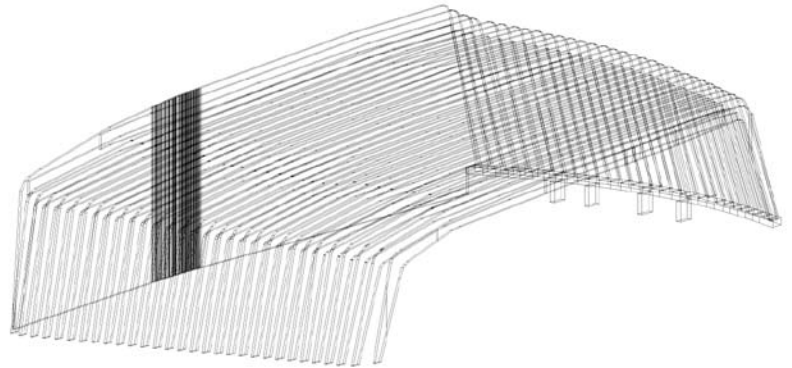

## THE VENICE BIENNALE

Founded in 1893 as a national biennial art exhibition, The Venice Biennale is the oldest and most prestigious cultural institution in the world. Today, The Venice Biennale is an interdisciplinary foundation dealing with architecture, the visual arts, cinema, dance, music and theater. Each year, it produces major international events for each of these disciplines, namely the Venice International Film Festival.

The increasing size of these events, both in participants and attendees, has required increasingly larger venues to accommodate them. Future success of the Venice International Film Festival, as well as the economy of the Lido—the island adjacent to Venice where the current festival structures exist, depends on having adequate space and structures to accommodate growing crowds.